

# ASSEMBLY INSTRUCTIONS

Read these instructions carefully. Refer hardware and furniture parts list for quantities. Be sure all parts are complete, before assembling. Place all furniture part on a clean and flat soft surface to prevent damage. Refer steps provided as assembling guide.

**NOTES :**  
Do not **FULLY-TIGHTEN** the nuts or nut bolts until all are in place. To prevent thread damage. Ensure that nuts or nut bolts are not over-tightened. Hardware are to be kept out of reach from children.

PART LIST			HARDWARE LIST		
ITEM	DESCRIPTION	QTY	ITEM	DESCRIPTION	QTY
A	CHAIR BACK	1 PC	1	JCBC SCREW M6 x 60MM(BLK)	2 PCS
B	CUSHION SEAT	1 PC	2	JCBC SCREW M6 x 70MM(BLK)	4 PCS
C	CHAIR LEG ( L & R )	2 PCS	3	SPRING WASHER 1/4"	6 PCS
D	RAIL	1 PC	4	M4 ALLEN KEY (BALL SHAPE) LONG	1 PC
			5	BARREL NUT M6 X 13MM	2 PCS
			6	WOOD DOWEL DIA 10 X 35MM	2 PCS
			7	PAN HEAD SCREW M5 X 32MM	2 PCS

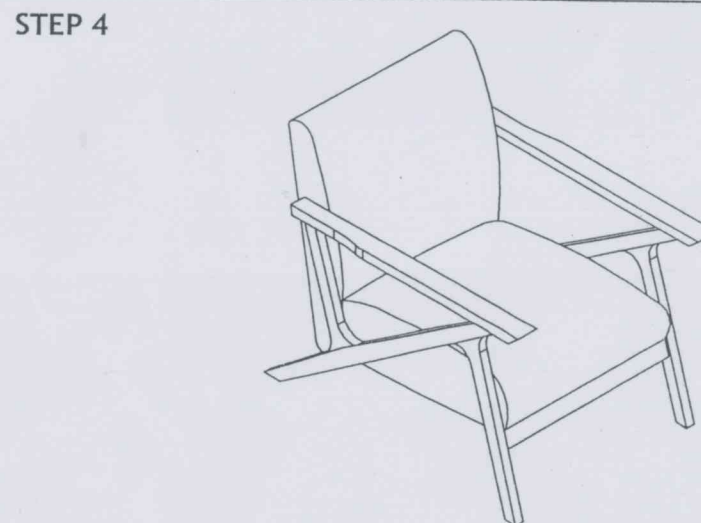
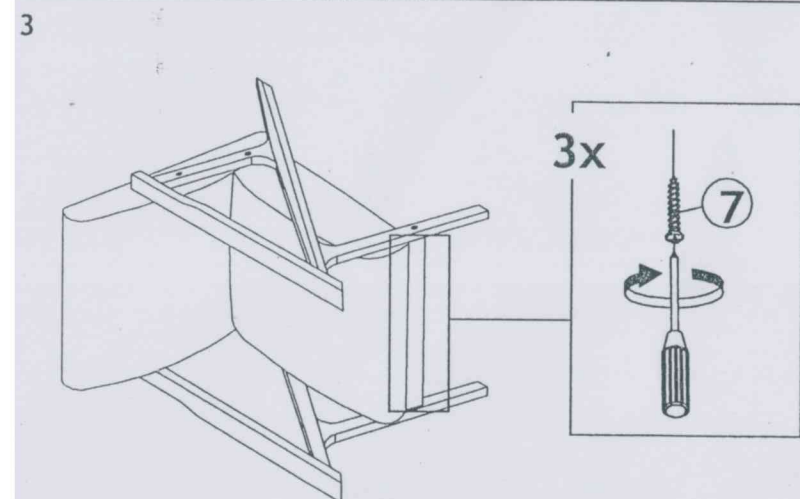
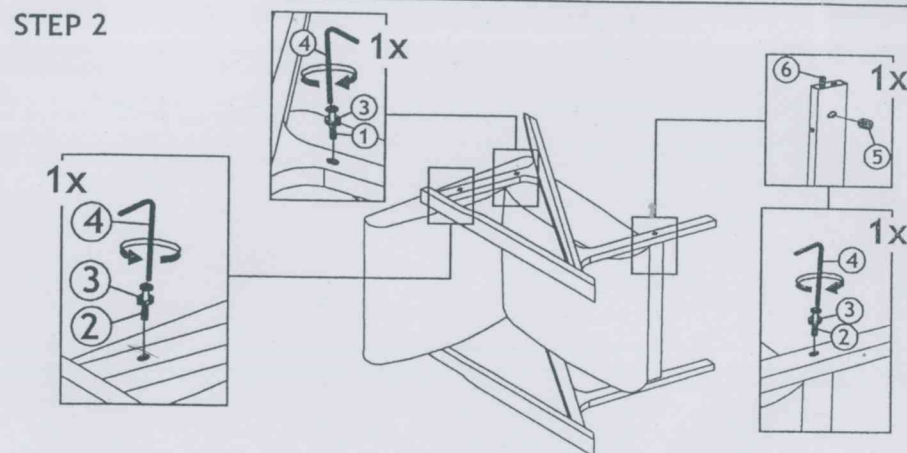
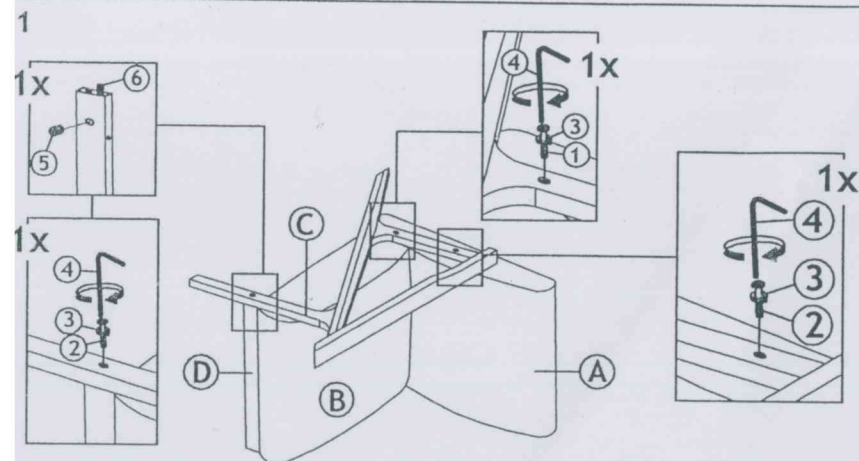

ASSEMBLY COMPLETED