

# Mod. **VELONDRA**

## **BED**

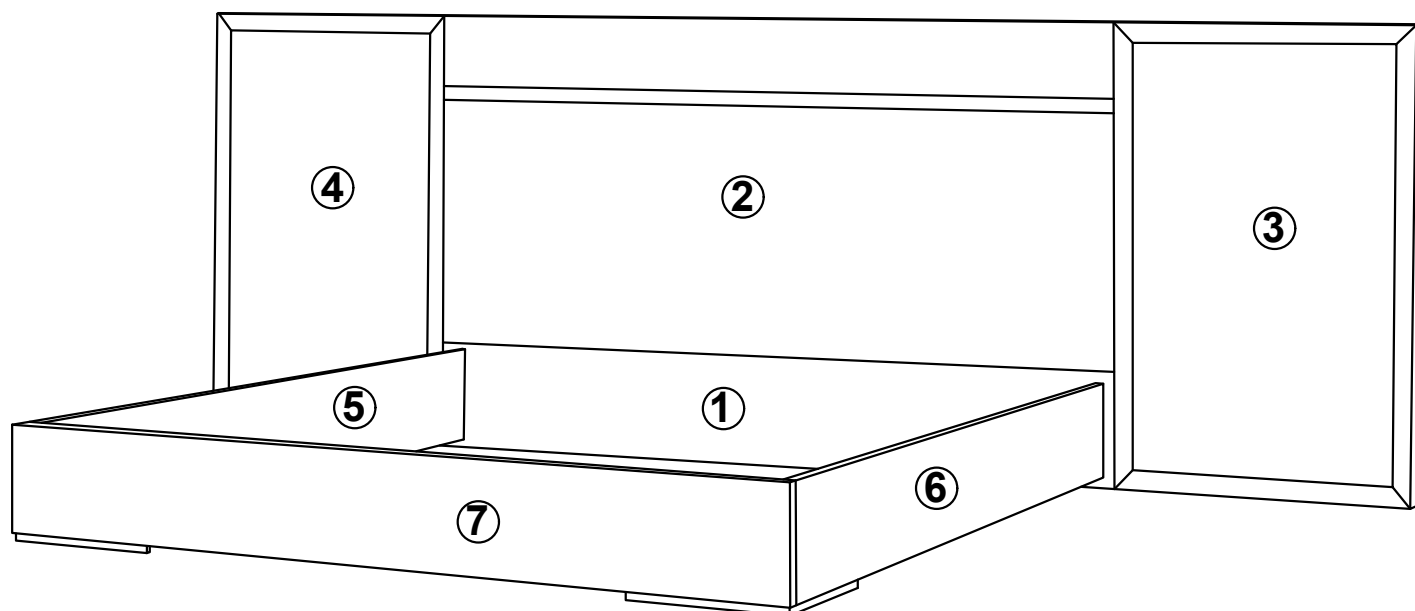

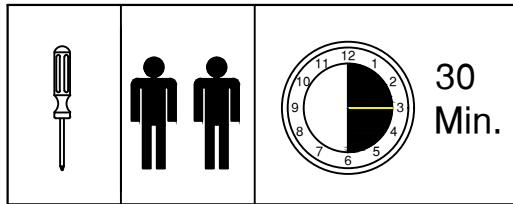

**B**

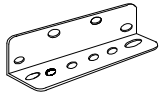

1FEVAPI10113

**2x**

**C**

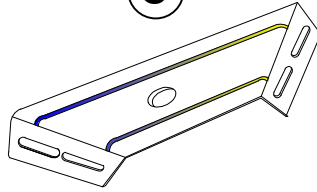

1FEVAPI10102

**4x**

**D**



6MAx15

1FEVTTB10615

**20x**

**E**

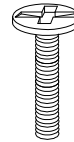

6MAx30

1FEVTTB10630

**36x**

**H**

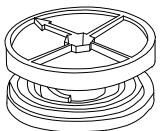

1FEGIMO10042

**8x**

**I**

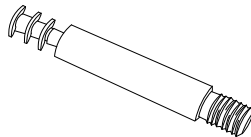

1FEGIPEF0042

**8x**

**M**



Ø 8x30

1FEVACIL0830

**8x**

**N**

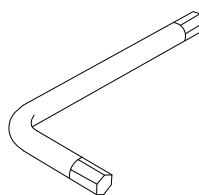

1FEVASE10510

**1x**

**O**

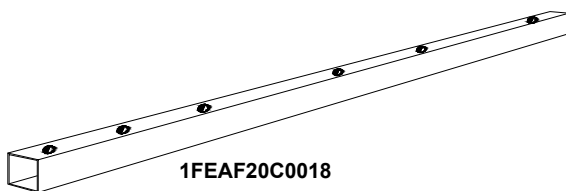

1FEAF20C0018

**2x**

**S**

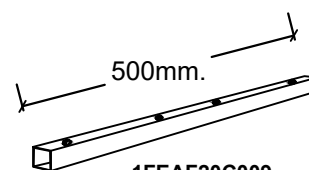

500mm.

1FEAF20C009

**6x**

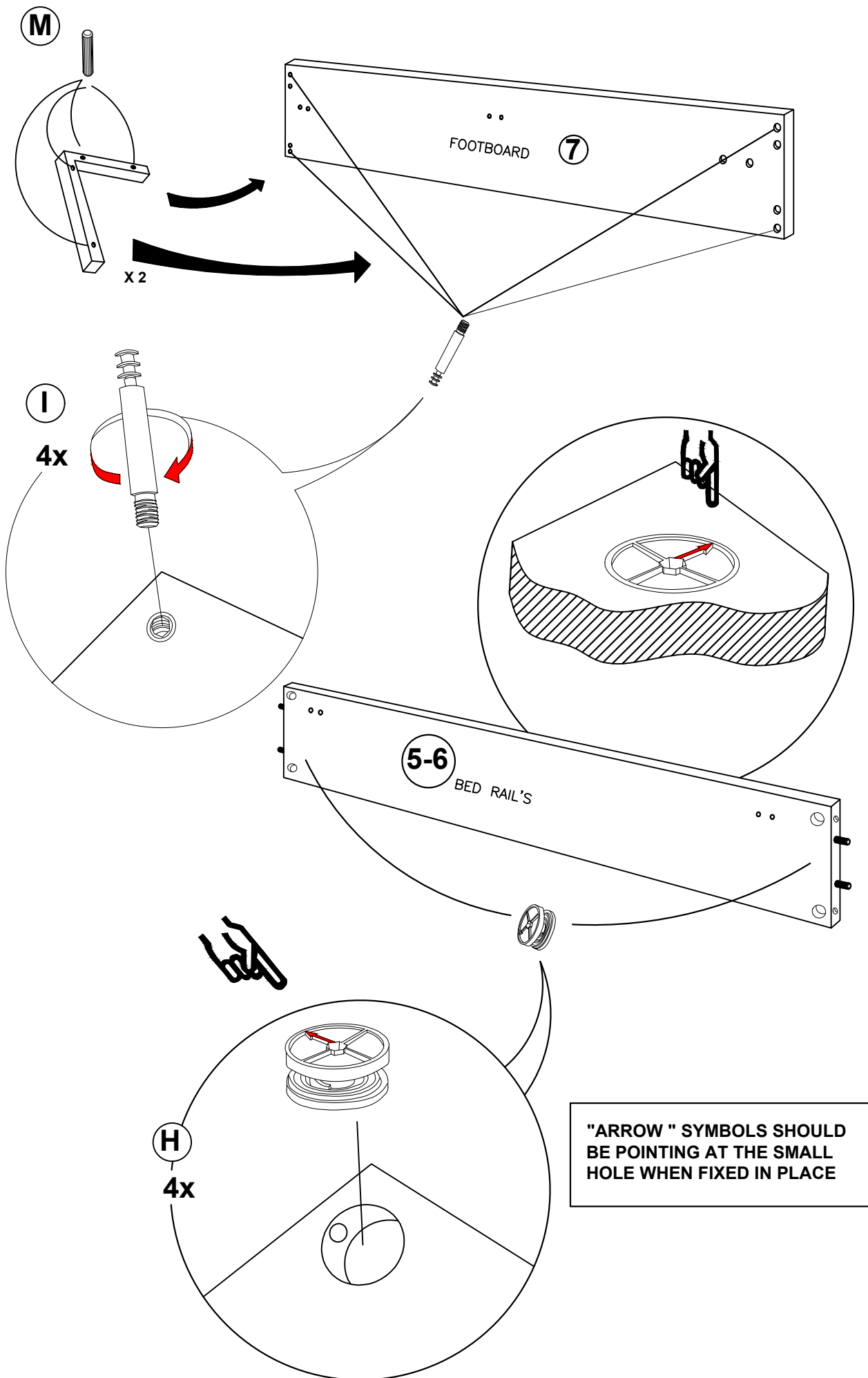

"IT'S VERY IMPORTANT TO TIGHTEN EACH PIECE INCREMENTALLY, ALTERNATING BETWEEN TOP AND BOTTOM IN ORDER TO TIGHTEN FULLY AND EVENLY."

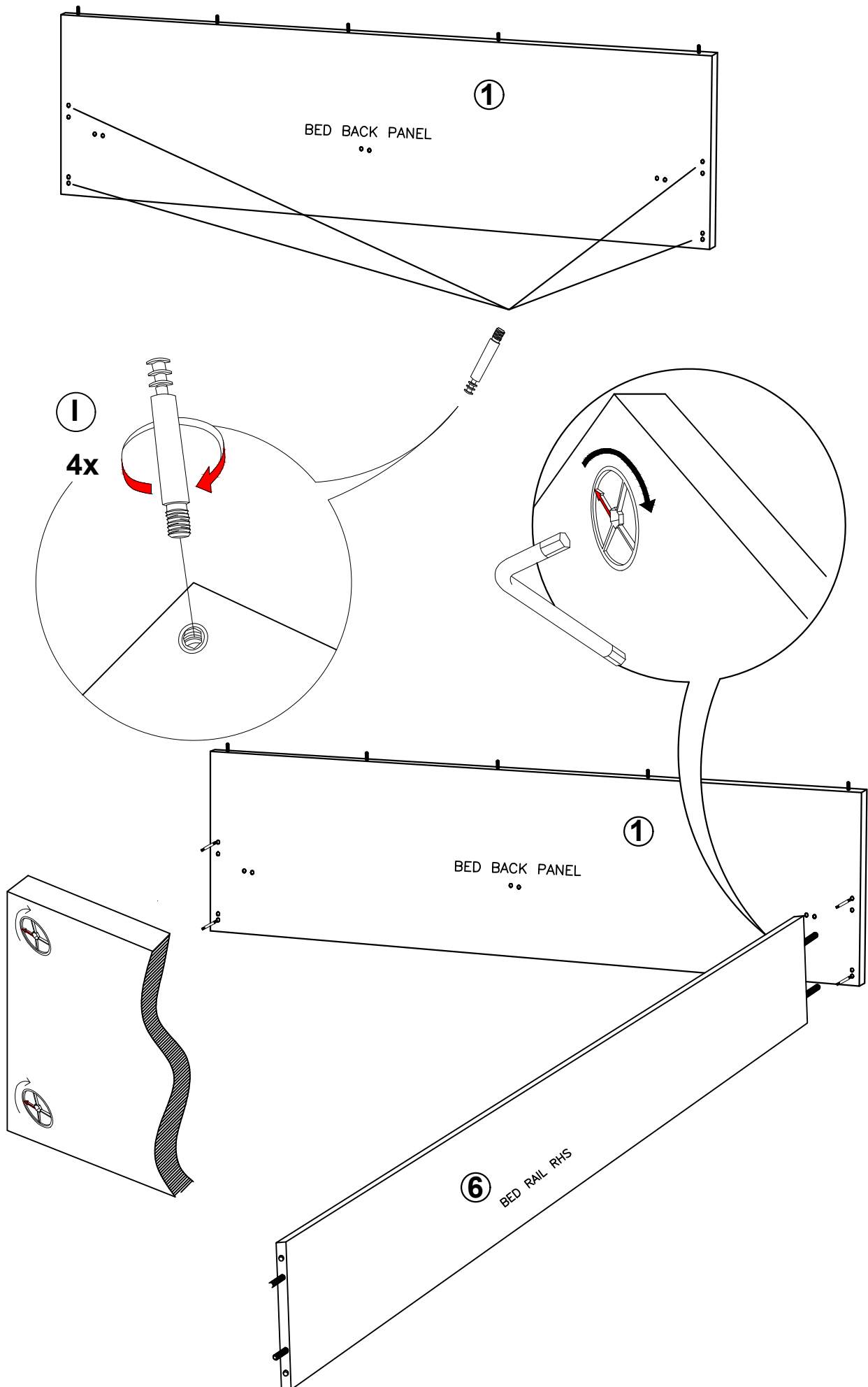

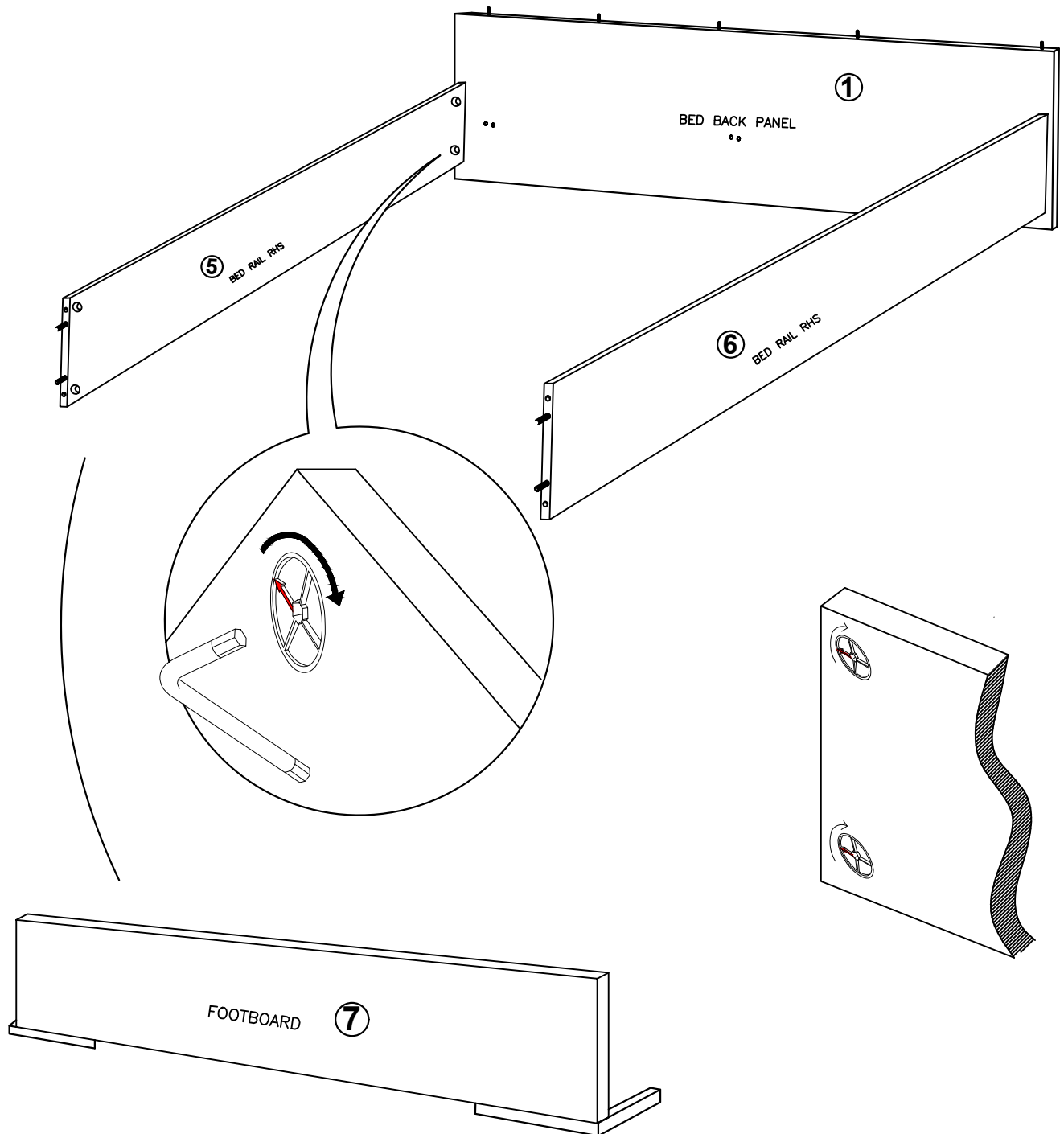

**"IT'S VERY IMPORTANT TO TIGHTEN EACH PIECE INCREMENTALLY, ALTERNATING BETWEEN TOP AND BOTTOM IN ORDER TO TIGHTEN FULLY AND EVENLY."**

