

ASSEMBLY INSTRUCTIONS

Read this instruction carefully. Refer hardware and furniture parts list for guidance. Be sure all parts are complete, before assembling. Place all wooden furniture part on a clean and flat soft surface to prevent scratcheds. Refer steps provided as assembling guide.

CAUTIONS :

1. Do not **FULLY-TIGHTEN** the nuts or nut bolts until all are in place.
2. To prevent thread damage. Ensure that nuts or nut bolts are not over-tighten.
3. Hardware are to be kept out of reach from children.

| PART LIST | | | HARDWARE LIST | | |
|-----------|---------------------|--------|---------------|--------------------------------|--------|
| ITEM | DESCRIPTION | QTY | ITEM | DESCRIPTION | QTY |
| A | HEADBOARD | 1 PC | 1 | JCBB SCREW M8 x 16MM | 8 PCS |
| B | FOOTBOARD | 1 PC | 2 | ALLEN KEY M5 (SHORT) | 1 PC |
| C | SIDE TABLE | 2 PCS | 3 | JCBC SCREW M6 x 50MM | 5 PCS |
| D | SIDE RAIL (L & R) | 2 PCS | 4 | SPRING WASHER 1/4" | 5 PCS |
| E | SLAT | 11 PCS | 5 | PAN HEAD SCREW M4 x 25MM | 28 PCS |
| F | CENTER SLAT | 1 PC | 6 | PAN HEAD SCREW M4 x 32MM | 16 PCS |
| G | CENTER SLAT SUPPORT | 3 PCS | 7 | ALLEN KEY M4 BALL SHAPE (LONG) | 1 PC |
| H | SLAT WITH HOLE | 3 PCS | 8 | ADJUSTABLE SCREW | 3 PCS |
| | | | 9 | WOOD DOWEL DIA Ø8 - 25mm | 16 PCS |
| | | | 10 | FLAT WASHER 1/4" | 2 PCS |

STEP 1

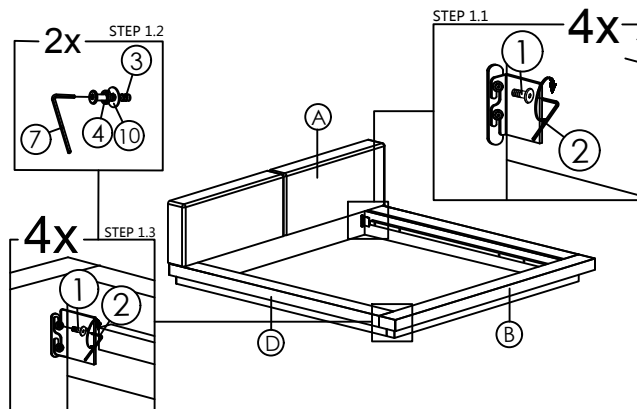

STEP 2

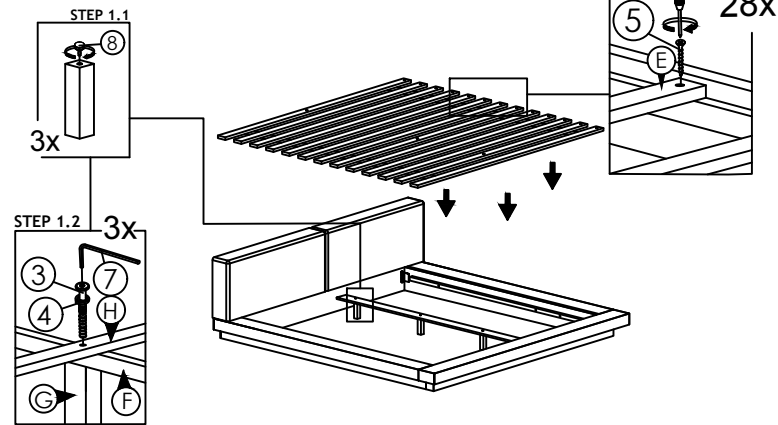

STEP 3

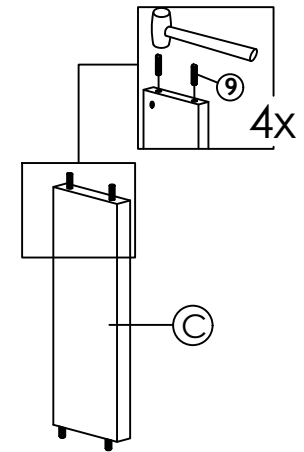

STEP 4

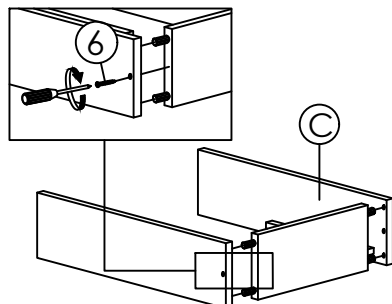

STEP 5

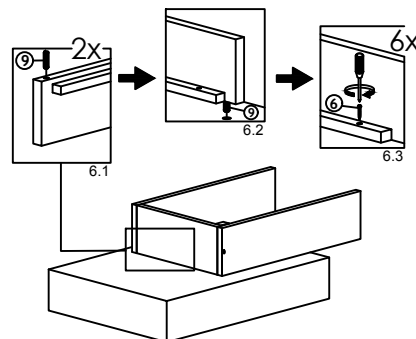

STEP 6

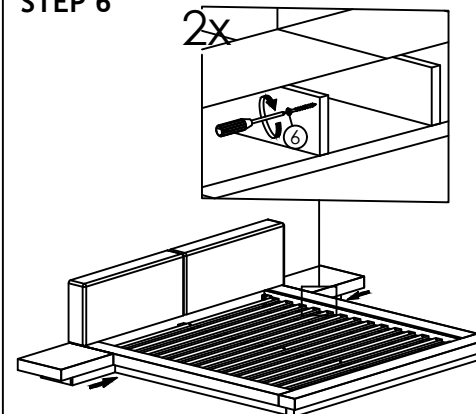

STEP 7

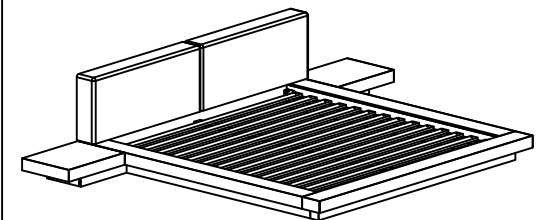

ASSEMBLY COMPLETED