

RANGOLI ASSEMBLY INSTRUCTIONS

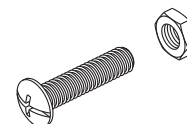
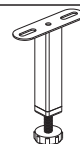
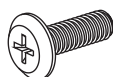
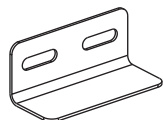
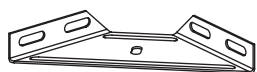
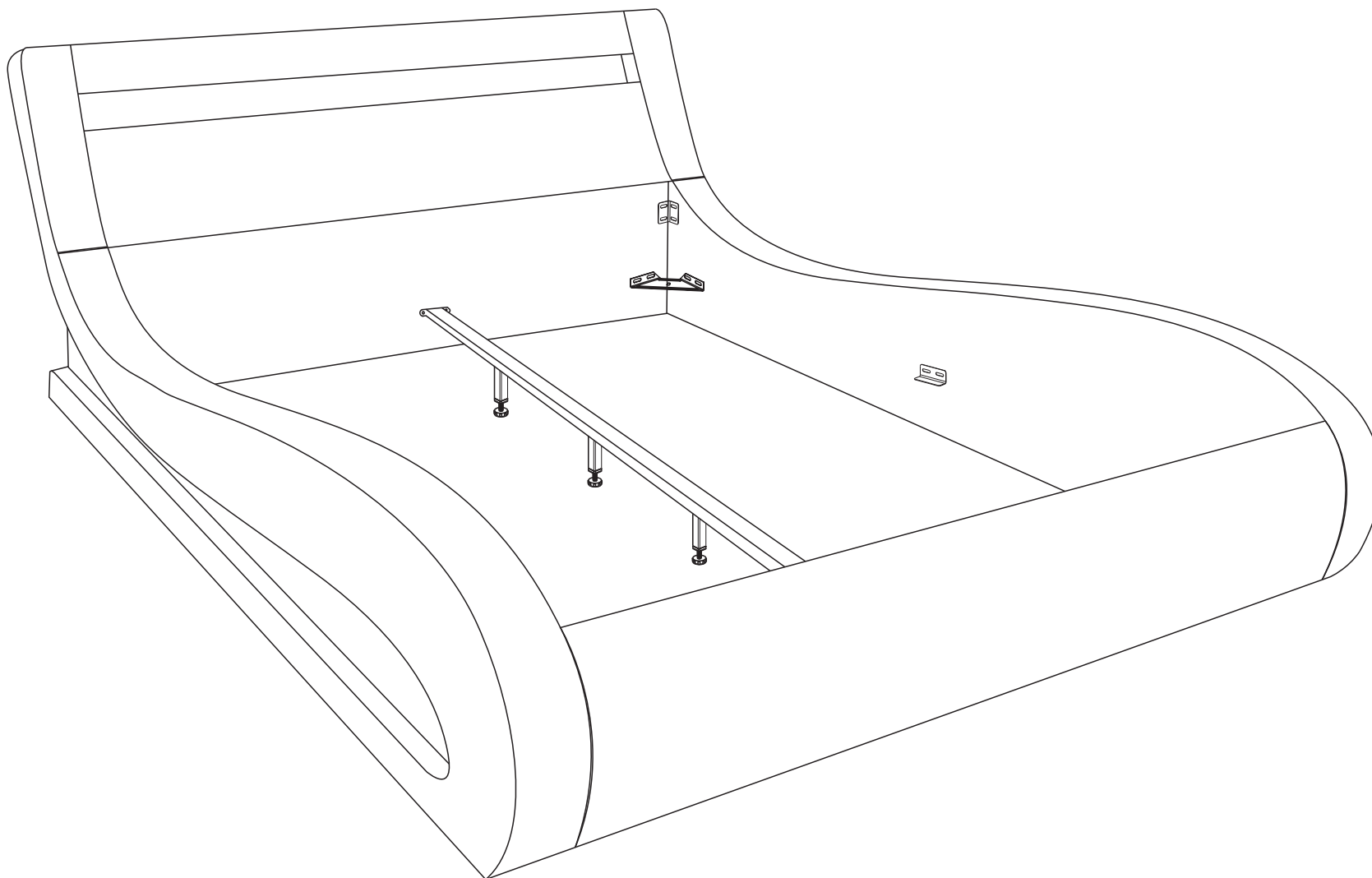

L:4

H:4

O:2

K:42

M:5

L:4

A detailed line drawing of a mechanical watch movement, viewed from the side. The movement is shown in a perspective view, highlighting its curved, barrel-like shape. Several components are labeled with letters in circles:

- A**: Points to the main plate or movement body.
- B**: Points to the winding crown or pusher.
- C**: Points to the winding mechanism, specifically the winding crown and its internal components.
- D**: Points to the main plate or movement body.
- H**: Points to the winding crown.
- K**: Points to the winding mechanism, specifically the winding crown and its internal components.
- L**: Points to the winding mechanism, specifically the winding crown and its internal components.

The diagram illustrates the internal mechanical components of the watch, including the winding mechanism, the main plate, and the movement body.

This diagram illustrates the assembly of the rear section of the boat hull. It shows the transom (labeled A) being attached to the hull. A rear crossbar (labeled B) is shown being installed into the hull. The diagram also shows the installation of the rear crossbar (labeled C) and the rear crossbar (labeled D). A detailed inset shows the assembly of the rear crossbar (labeled K) using a bolt (labeled M) and a washer (labeled K).