

# ASSEMBLY INSTRUCTIONS

Read this instruction carefully. Refer hardware and furniture parts list for guidance. Be sure all parts are complete, before assembling. Place all wooden furniture part on a clean and flat soft surface to prevent scratches. Refer steps provided as assembling guide.

## CAUTIONS :

- 1.Do not **FULLY-TIGHTEN** the nuts or nut bolts until all are in place.
- 2.To prevent thread damage.Ensure that nuts or nut bolts are not over-tightened.
- 3.Hardware is to be kept out of reach of children.

PART LIST			HARDWARE LIST		
ITEM	DESCRIPTION	QTY	ITEM	DESCRIPTION	QTY
A	DRESSER	1 PC	1	JCBC SCREW M6 x 40MM	8 PCS
B	LEGS	4 PCS	2	SPRING WASHER 1/4"	8 PCS
			3	FLAT WASHER 1/4"	8 PCS
			4	ALLEN KEY M4 (BALL SHAPE) LONG	1 PC
7	L-BRACKET	2 PCS	5	WALL SCREW M4 x 18MM	1 PC
8	BELT	1 PC	6	WALL SCREW M4 x 50MM	1 PC

## STEP 1

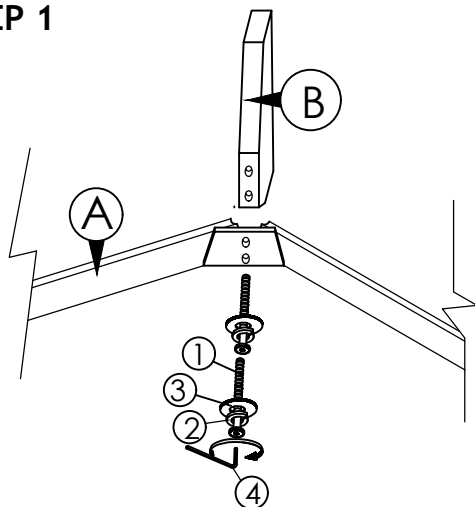

## STEP 2

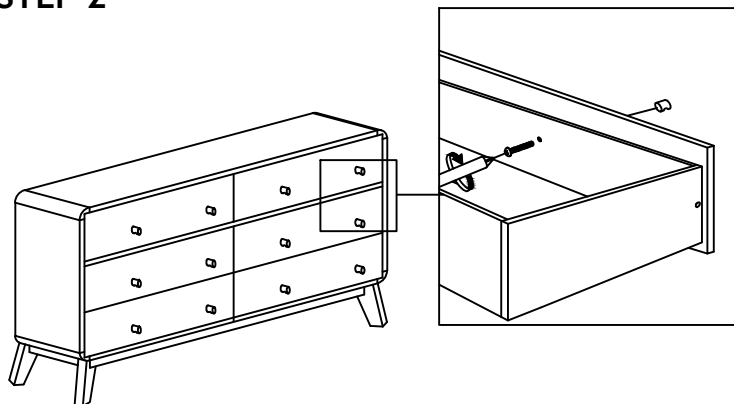

## STEP 3

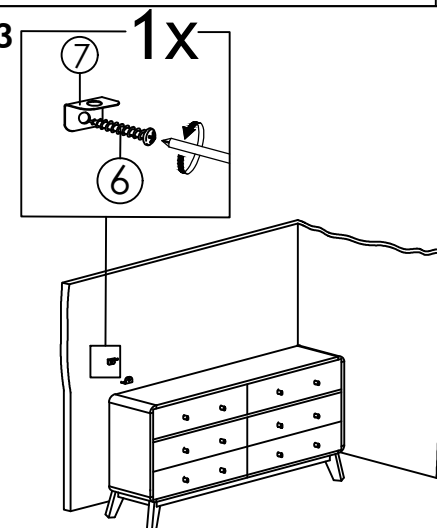

## STEP 4

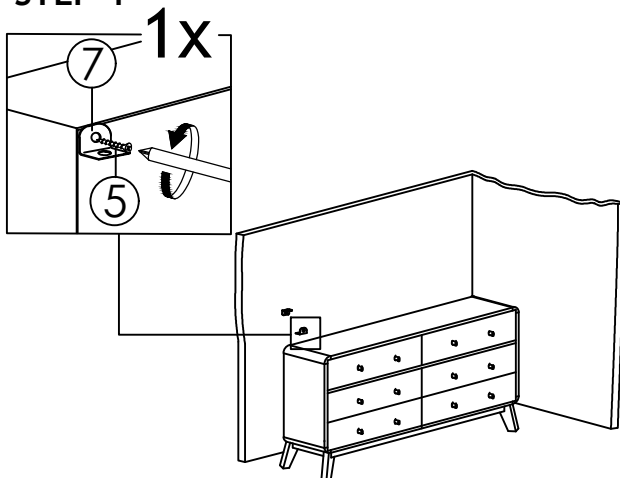

## STEP 5

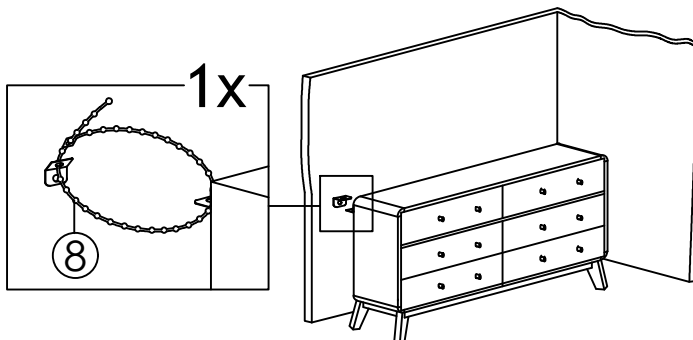

## STEP 6

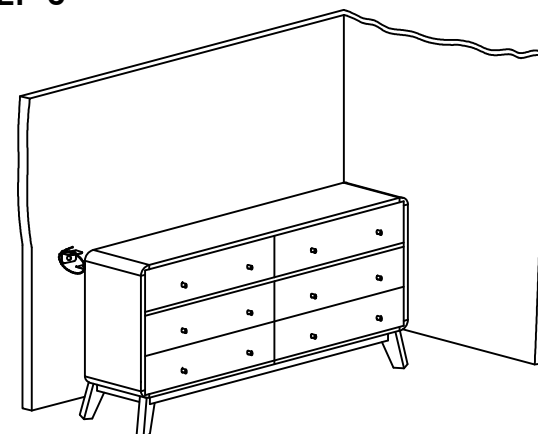

ASSEMBLY COMPLETED