

# ASSEMBLY INSTRUCTIONS

Read these instructions carefully. Refer to hardware and furniture parts list for guidance. Be sure all parts are complete, before assembling. Place all wooden furniture parts on a clean and flat soft surface to prevent scratches. Refer to steps provided as assembling guide.

## CAUTIONS :

1. Do not **FULLY-TIGHTEN** the nuts or nut bolts until all are in place.
2. To prevent thread damage. Ensure that nuts or nut bolts are not over-tightened.
3. Hardware is to be kept out of reach of children.

PART LIST		
ITEM	DESCRIPTION	QTY
A	CUSHION BACK	1 PC
B	CUSHION SEAT	1 PC
C	CHAIR LEG (L & R)	2 PCS
D	FRONT RAIL	1 PC
E	BACK RAIL	1 PC
8	WOOD BUTTON 14.5mm	4 PCS

HARDWARE LIST		
ITEM	DESCRIPTION	QTY
1	JCBC SCREW M6 x 45MM	4 PCS
2	JCBC SCREW M6 x 50MM	4 PCS
3	SPRING WASHER 1/4"	8 PCS
4	WOOD DOWEL DIA 8 x 25MM	2 PCS
5	WOOD DOWEL DIA 8 x 35MM	8 PCS
6	M4 ALLEN KEY (BALL SHAPE) LONG	1 PC
7	PAN HEAD WOOD SCREW M4 X 38mm	10 PCS

## STEP 1 :

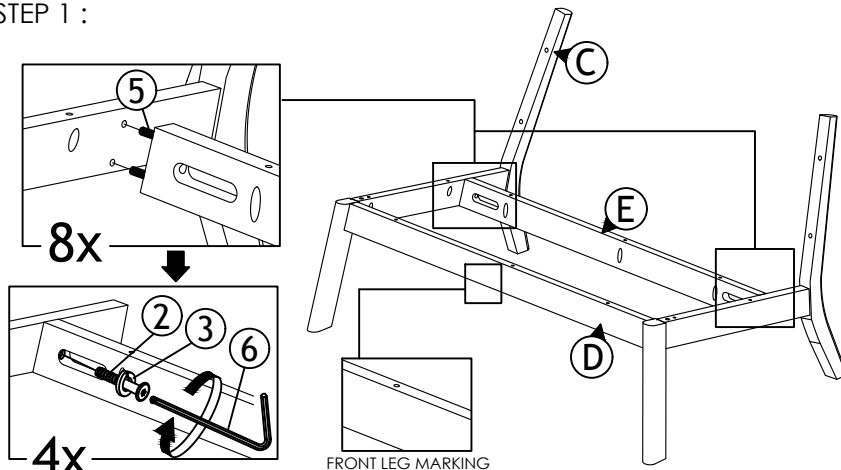

## STEP 2 :

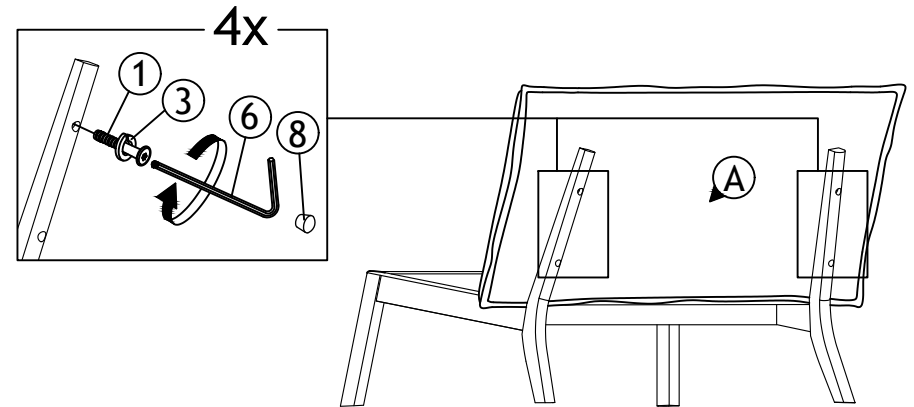

## STEP 3 :

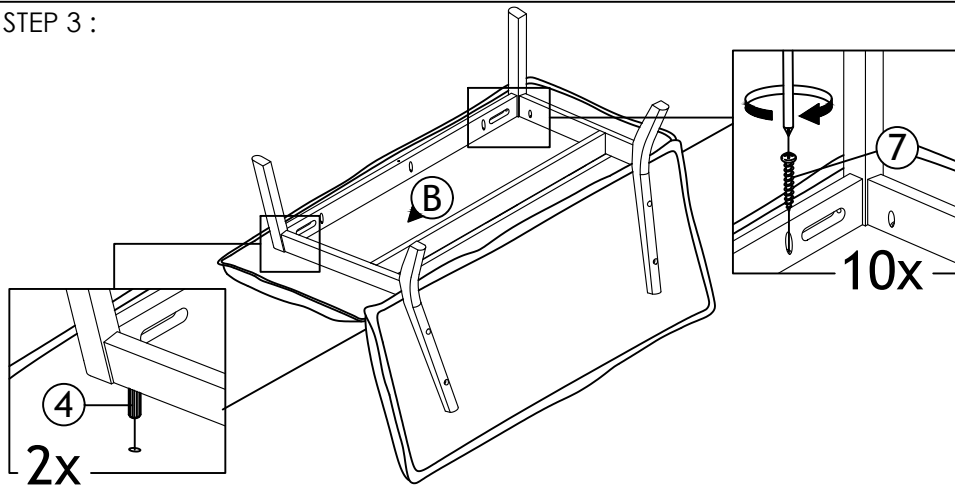

## STEP 4 :

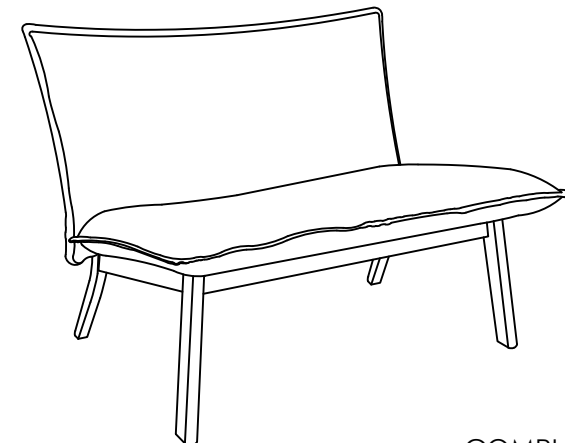

COMPLETED ASSEMBLY