

BT02A

①

This diagram illustrates the first step of assembly. On the left, a wire mesh cabinet is shown with its top and bottom drawers partially pulled out. A small black arrow points to the right, indicating the direction of movement for the front panel. On the right, the front panel is shown attached to the cabinet. A large black arrow points from the left cabinet to the right cabinet. The front panel has a circular label with the number '1' on its left side.

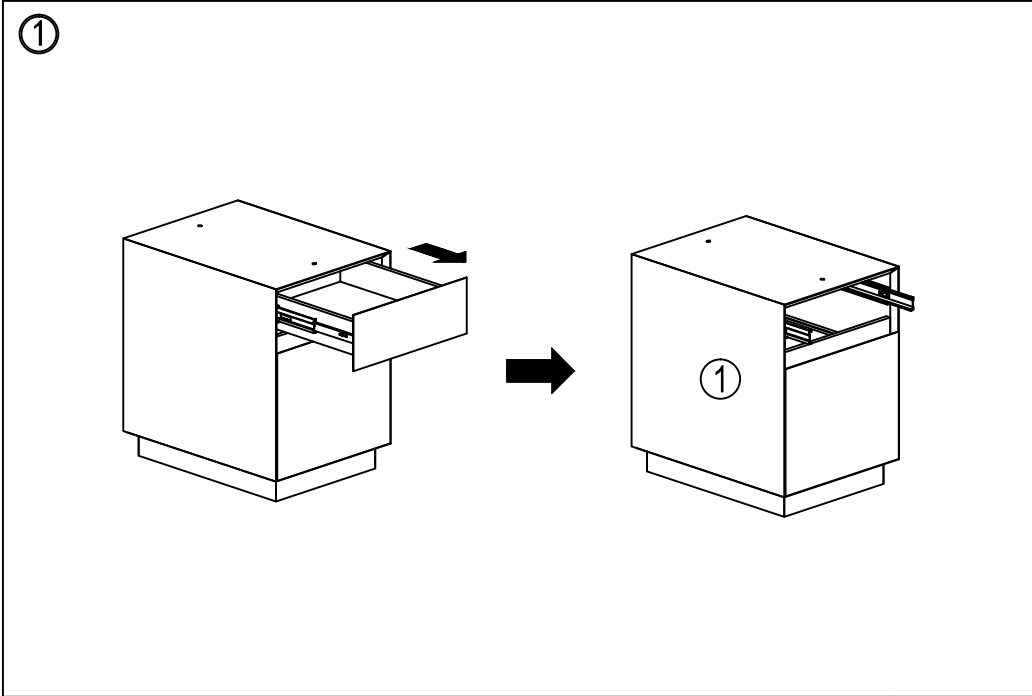

②

A=3
B=3
C=1

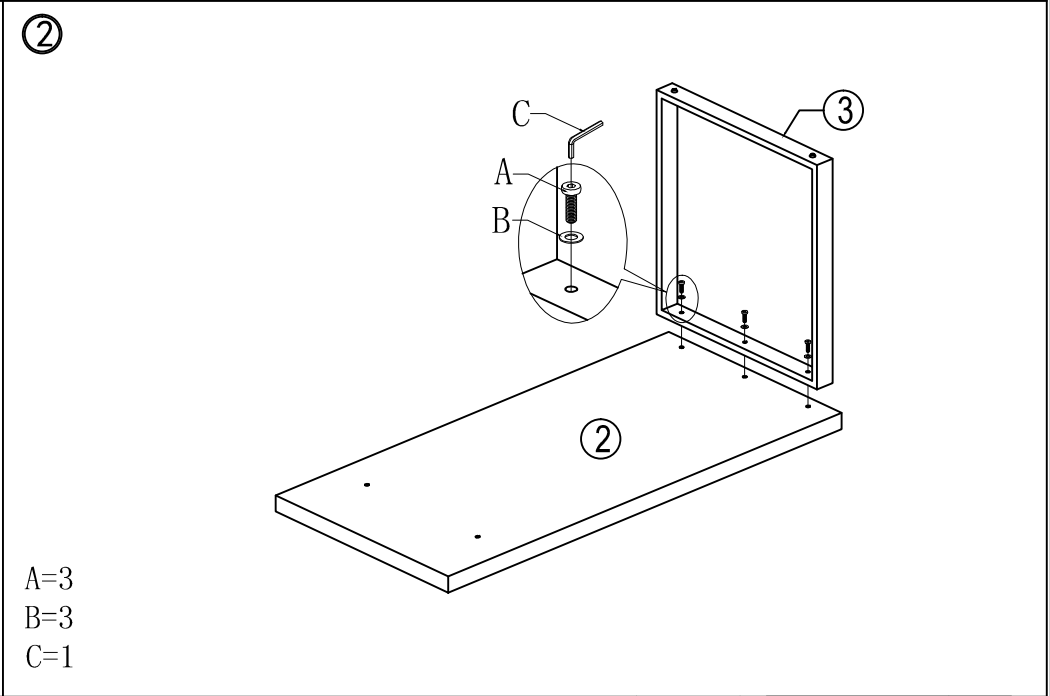

②

A=3
B=3
C=1

③

B=2
D=2

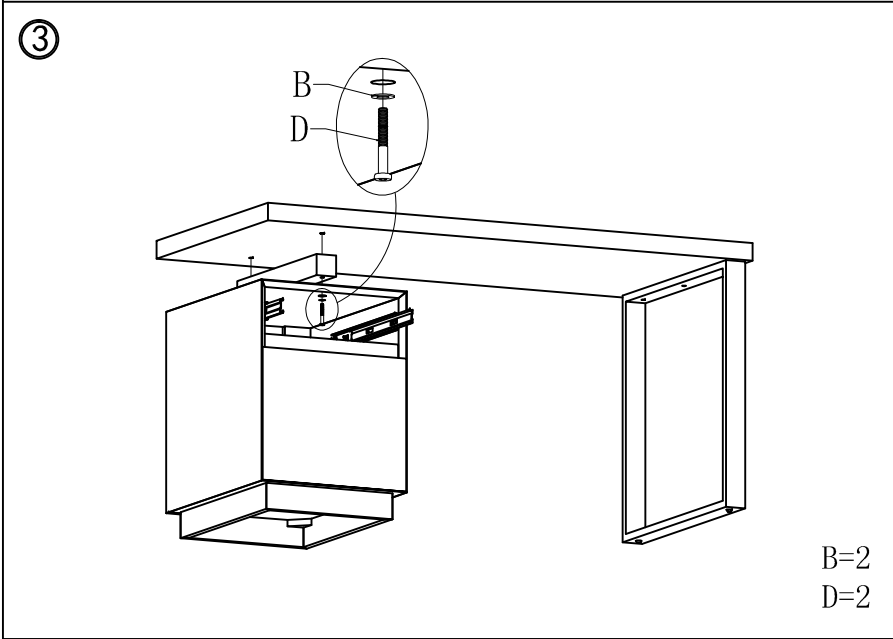

③

B=2
D=2

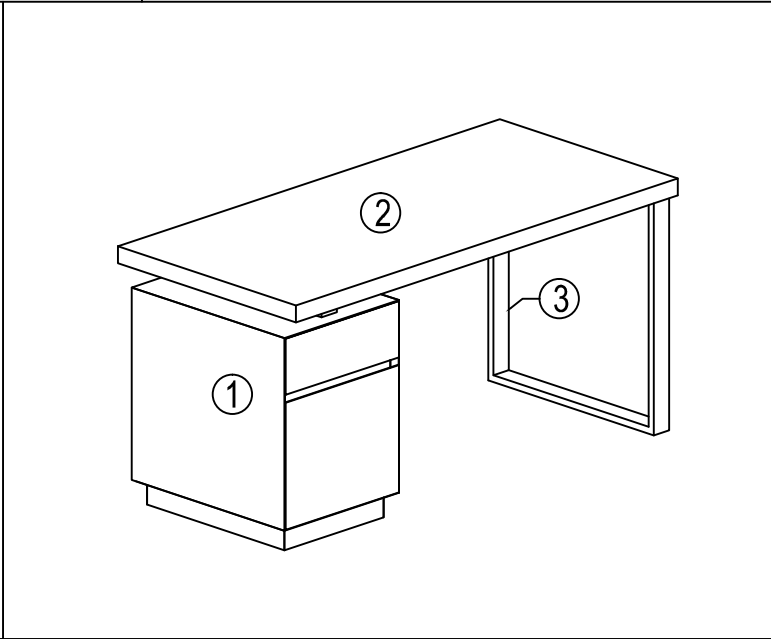
[illegible]