

# GD8684 INSTRUCTION

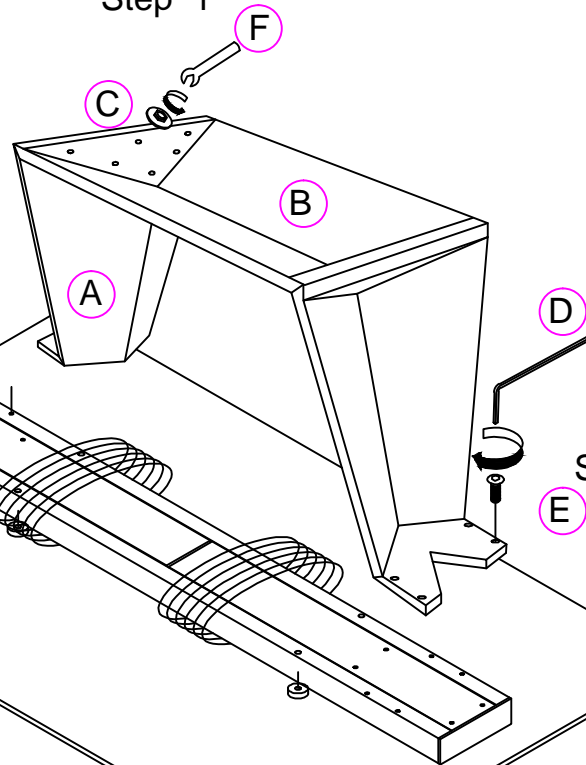

Step 1



Step 2

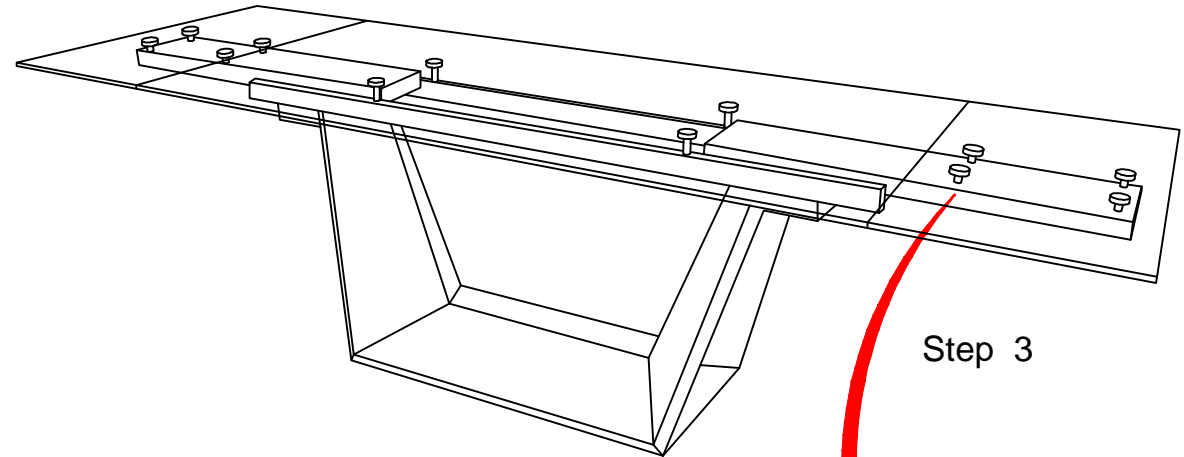

Step 3

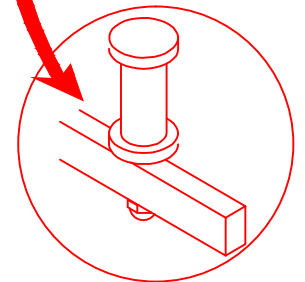

Attention:  
if you find the small glass not flat with the big glass, please adjust  
here to keep the same level.

## HARDWARE

A x 2pcs	B x 1pc	C x 12pcs for legs + base	D x 1pc	E x 8pcs for legs+ slide	F x 1pc